

REACH R LI REACH R-LI T

QUICK START GUIDE



Device Compatibility
Check

Please refer to your
Owner's Manual for more
in-depth instructions

REXTON

hearing.rexton.com

Charge Your Hearing Aids:

1. Place your hearing aids in the charger
 - ▶ A full charge takes about 4 hours
 - ▶ After 30 minutes it is possible to use your hearing aids for up to 6 hours
 - ▶ We recommend charging nightly so you can start your day fully charged



LED Light Status	Description
No LED light	No hearing instrument is in the charger, a hearing instrument is not placed correctly, or the charger is discharged
Flashing green LED light	Charging in progress
Solid green LED light	Hearing aid is fully charged

2. Turning Your Hearing Aids On/Off

Using the charger

Your hearing aids turn on automatically when removed from the charger. The hearing aids turn off automatically when placed back into the charger.

Using the Rocker Switch

- ▶ On: Press and hold the lower part of the rocker switch until the startup melody starts to play
- ▶ Off: Press and hold the lower part of the rocker switch until the power down melody is played



3. Inserting Your Hearing Aids

Your hearing aids have been fine-tuned for your right and left ear. Red marker indicates right ear. Blue marker indicates left ear.

1. Hold the receiver cable at the bend closer to the eartip piece. Carefully push the eartip piece in the ear canal. Twist it slightly until it fits well. Open and close your mouth to avoid accumulation of air in the ear canal.
2. Lift the hearing aid and slide it over the top of your ear.
3. If there is a retention strand attached, bend the retention strand and position it carefully into the bottom of the bowl of your ear.

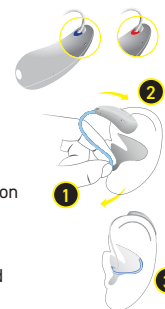

Controlling Volume and/or Programs

The Rexton app can adjust many functions (See Rexton App section). Your Hearing Care Professional can personalize the P3 switch to adjust volume or programs.

Press upper part of rocker switch to increase volume or program. 1

Press lower part of rocker switch to decrease volume or program. 2



Download the Rexton App to Your Smartphone

Scan the QR code below or go to the App Store (iOS) or Google Play (Android) and download the app.



iOS



Android

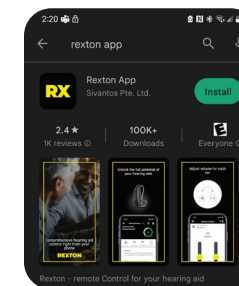
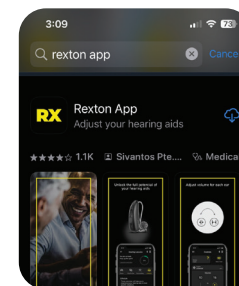

Pair Your Hearing Aids Your Smartphone

Turn your hearing aids off and back on, using either the charger or your rocker switch, to start your 3-minute discovery mode and follow directions on next page.

Important Notes and Recommendations for Charging Lithium-Ion Batteries

Your hearing aids and your travel charger utilize lithium-ion charging technology.

Your Hearing Aids:

We recommend charging the hearing instruments daily, even if the power cell is not empty. Charge them overnight so you can be sure to start your day with fully-charged hearing instruments. If you do not intend to wear your hearing aids for a long period of time (several days or weeks) we recommend you store your hearing aids in either charger and keep it plugged into a power outlet. You may also turn off your hearing aids via the rocker switch and store them safely. If you do not intend to wear your hearing aids for a long period of time (many weeks or months) we recommend you fully charge your hearing aids and then turn them off via the rocker switch. You may then store them in the standard charged that is not plugged into a power outlet, or in the travel charger that has been fully charge and powered off by pressing and holding the power button for 5-7 seconds until all lights turn off.

Important: We recommend you charge the hearing instruments every 3 months and you must charge them at least every 6 months. At 6 months the hearing aids are at risk of having an unrecoverable deep-discharge of the power cell. Deep-discharged power cells cannot be charged anymore and they have to be replaced.

Your Travel Charger

It is important to regularly charge your travel charger. It is acceptable to keep it continuously plugged into a power outlet. It is also safe to charge it bi-weekly, weekly or monthly depending on how often you are charging your hearing aids using the internal lithium-ion power cell. If you are not using your travel charger as a charger you should charge it every 6 months. You must charge it every 12 months to avoid having an unrecoverable deep-discharge of the power cell. Deep-discharged power cells cannot be charged anymore and they have to be replaced.

Distributor

WS Audiology USA, Inc.
101 Wood Ave South, 7th floor
Iselin, NJ 08830
Phone: (800) 766-4500
Fax: (732) 562-6696



Apple and the Apple logo are trademarks of Apple Inc., registered in the U.S. and other countries. App Store is a service mark of Apple Inc. Apple is not responsible for the operation of this device or its compliance with safety and regulatory standards. Please note that the use of this accessory with iPhone or iPad may affect wireless performance. iPad, iPhone are trademarks of Apple Inc., registered in the U.S. and other countries. The Android name, the logo, and other trademarks are property of Google LLC. The Bluetooth® word mark and logos are owned by the Bluetooth SIG, Inc. and any use of such marks by WSAUD A/S is under license. Other trademarks and trade names are those of their respective owners.

Copyright © 2023 Rexton is a registered trademark of WSAUD A/S.
Document No. D21036713 PN 21036713 12/23 SIV-18174-23

Pairing to iPhone®

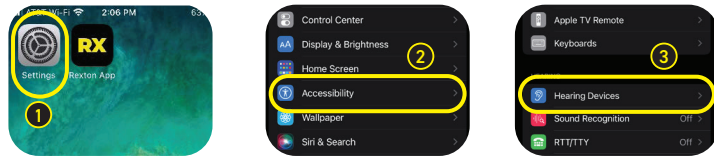

1. Tap **Settings**, Turn on **Bluetooth**
2. Scroll down and tap **Accessibility**
3. Scroll down and tap **Hearing Devices**
4. Select **your hearing aids**
5. Tap **Pair** for each hearing aid

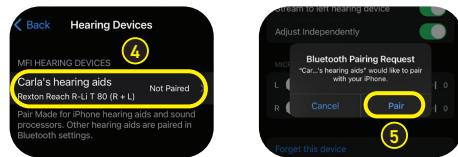

Pairing to Android

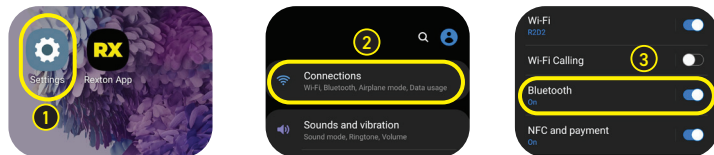

1. Tap **Settings**
2. Tap **Connections**
3. Tap **Bluetooth**, turn on and **scan**
4. Tap your **first hearing aid** and **pair**
Tap your **second hearing aid** and **pair**
5. Tap back to **Bluetooth**
You should see **2 devices connected**

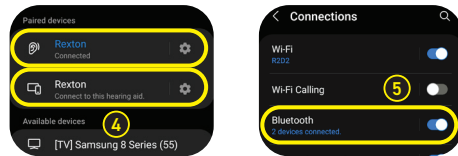

Using Your Hearing Aids with Your Smartphone

	iPhone	Android
Answer Call	Answer on phone or short-press rocker switch on hearing aid	Answer on phone
End or Reject Call	End/Reject on phone or long-press rocker switch on hearing aid	End/Reject on phone
Speaking	<ul style="list-style-type: none"> Your voice is picked up by the hearing aid microphones You do not need to hold the phone for the caller to hear you 	<ul style="list-style-type: none"> Your voice is picked up by the phone microphone You should hold the phone close for the caller to hear you
Making a Call	Enter the phone number and press the dial button or use voice commands like "Hey Siri" or "Hey Google"	

Streaming Requirements

iPhone:

- Direct streaming** calls and audio requires iOS 12 or later
- HandsFree** functionality requires iPhone 11 or newer and iOS 15.2 or newer

Android:

- Direct streaming** calls and audio requires ASHA (Audio Streaming for Hearing Aids) protocol and Android OS 11 or higher

It is best practice to update your phone to the latest operating system possible.

Rexton App Controls

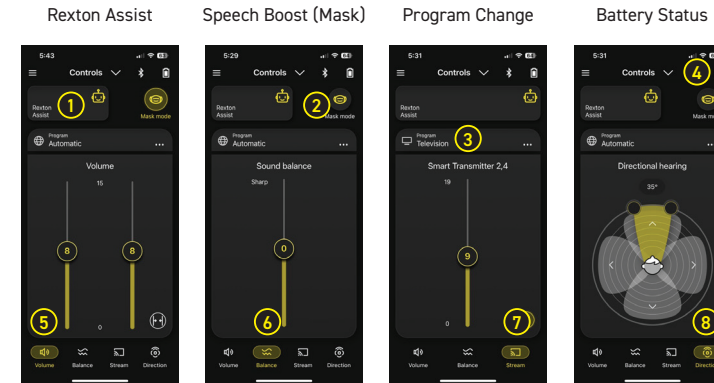

1. Rexton Assist: Tap to personalize your settings
2. Speech Boost: Tap to increase soft voices
3. Program Change: Tap if your HCP added dedicated programs
4. Battery Status: Tap to see your Bluetooth connection and battery status
5. Volume: Raise lower left/right individually or merge together
6. Sound Balance: Change the treble/bass balance
7. TV Stream: Adjust the volume from TV streamer
8. Directional Hearing: Focus your attention and reduce background sounds

Rexton Assist: Your Personal Concierge Service

Rexton Assist will automatically be activated in the Rexton App when your hearing aids are paired via Bluetooth. It's an Artificial Intelligence (AI) based feature that allows you to tailor your hearing experience in real time, when needed. Rexton Assist analyzes the environment around you and provides real time adjustments.

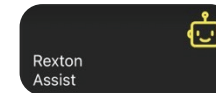

- 1 Tap Rexton Assist
- 2 Select Issue
- 3 Answer the questions
- 4 Rexton Assist adjusts your hearing aids
- 5 Choose to **Keep**, **Revert**, or **Improve Further**

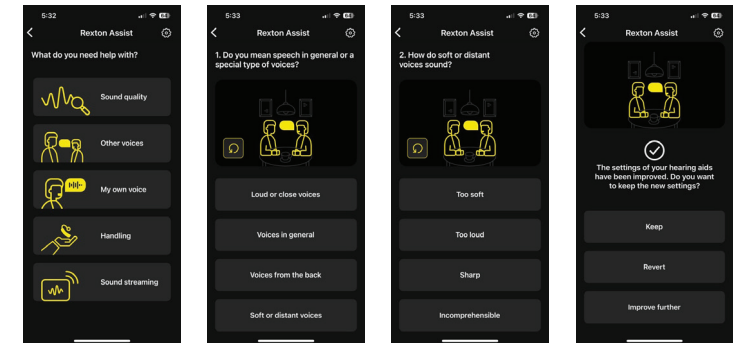

Note: To discard your current choices or Revert to your hearing care professional's settings Tap Settings and Restart or Reset

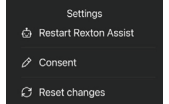

Remote Services

You may be able to participate in remote services. Please consult your Hearing Care Professional if you are interested. If activated, follow these steps at appointment time:

Open Rexton App

1. Tap Accept incoming call
2. Tap OK to start session
3. Tap OK to end session
4. Restart your hearing aids

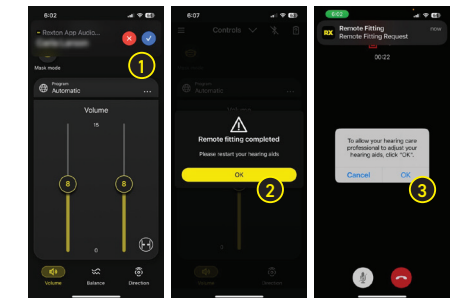

Remote Service Tips

- Make sure your phone and hearing aids are fully charged
- Have a strong (3+ bars) connection to cell data or WiFi signal
- Have your Rexton app open at appointment time