

BiCore C R-Li BiCore C R-Li T

RECHARGEABLE
HEARING AIDS



USER GUIDE 2
(INSTRUCTIONS FOR USE)

Made for
iPhone | iPad | iPod

hearing.rexton.com

REXTON



CAUTION

It is important to read this user guide and the user guide 1 (safety manual) thoroughly and completely. Follow the safety information to avoid damage or injury.

This User Guide is valid for:

Hearing

BiCore C R-Li

BiCore C R-Li T

Charger:

Charging Station R (RIC)

Travel Charger BiCore R

Intended use

Hearing aids are intended to improve the hearing of hearing impaired persons. Diagnosis and prescription of a hearing aid must be performed by hearing health specialists, e.g. acousticians, audiologists or ENT doctors.

The charger is intended to charge our specific hearing aids with built-in power cells (lithium-ion rechargeable batteries).

Use the hearing aids and accessories only as described in the user guide.

Content

Welcome	5
Your hearing aids	6
Hearing aid type	6
Getting to know your hearing aids	7
Components and names	7
Controls	10
Hearing programs	11
Daily use	12
Inserting and removing the hearing aids	12
Turning on and off	17
Switching to standby mode	18
Adjusting the volume	18
Changing the hearing program	19
Charging with the Standard Charger	19
Charging with the Travel Charger	22
Special listening situations	28
On the phone	28
Audio streaming with iPhone	28
Audio streaming with Android phone	29
Bluetooth	29
Audio induction loop	29

Maintenance and care	31
Hearing aids	31
Ear pieces	32
Professional maintenance	35
Important safety information for hearing aids and charger	36
Personal safety	37
Product safety	38
Safety information on lithium-ion rechargeable batteries	39
Further information	42
Accessories	42
Operating, transport, and storage conditions for the hearing aid	42
Operating, transport, and storage conditions for the charger	44
Technical data of the power supply adapter	45
Disposal information	45
Troubleshooting for hearing aid	45
Troubleshooting for charger	46
Symbols used in this document	47
Conformance information for the charger	48
Country-specific information	49
Service and warranty	50

Welcome

Thank you for choosing our hearing aids to accompany you through everyday life. Like anything new, it may take you a little time to become familiar with them.

This guide, along with support from your Hearing Care Professional, will help you understand the advantages and greater quality of life your hearing aids offer.

To receive the most benefit from your hearing aids, it is recommended that you wear them every day, all day. This will help you get adjusted to them.

i The device may not look exactly like the guiding illustrations in these instructions. We reserve the right to make any changes we consider necessary.

i Before using your hearing aids for the first time, fully charge them. Follow the instructions in the charger section of this user guide.

Your hearing aids



This user guide describes optional features that your hearing aids may or may not have.

Ask your Hearing Care Professional to indicate the features that are valid for your hearing aids.

Hearing aid type

Your hearing aids are a RIC (Receiver-in-Canal) model. The receiver is placed within the ear canal and connected to the hearing aid via a receiver cable. The hearing aids are not intended for children under the age of 3 years or persons with a developmental age of under 3 years.

A power cell (lithium-ion rechargeable battery) is permanently built into your hearing aid. This enables easy charging with Charging Station R.

The wireless functionality enables advanced audiological features and synchronization between your two hearing aids.

Your hearing instruments feature Bluetooth® low energy* technology allowing for easy data exchange with your smartphone, and for seamless audio streaming with your iPhone* and for some Android smartphones that support Audio Streaming for Hearing Aids (ASHA).

* The Bluetooth word mark and logos are owned by the Bluetooth SIG, Inc., and any use of such marks by WS Audiology Denmark A/S of this product is under licenses. Other trademarks and trade names are those of their respective owners.

Getting to know your hearing aids

It is recommended to familiarize yourself with your new hearing aids. With the hearing aids in your hand try using the controls and note their location on the hearing aid. This will make it easier for you to feel and press the controls while wearing the hearing aids.

i If you have problems pressing the controls of your hearing aids while wearing them, you can ask your Hearing Care Professional whether a remote control or a smartphone app to control your hearing aids is available.

Components and names

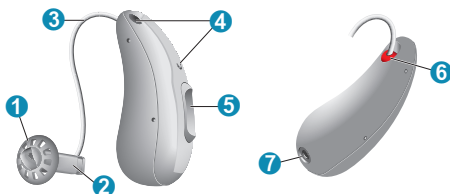

-
- | | |
|-----------------------|---|
| 1 Ear piece | 5 Rocker switch (control, on/off switch) |
| 2 Receiver | 6 Side indicator (red = right, blue = left) and receiver connection |
| 3 Receiver cable | 7 Charging contacts |
| 4 Microphone openings | |
-

* iPad, iPhone, and iPod touch are trademarks of Apple Inc., registered in the U.S. and other countries.

Travel Charger

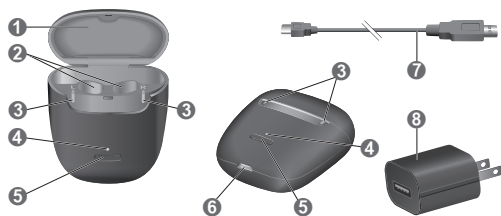

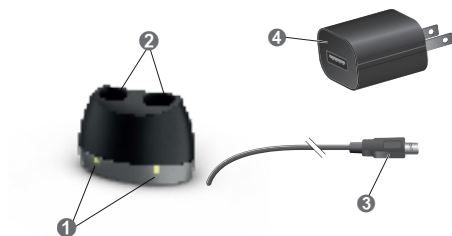

-
- | | |
|-----------------------------|-------------------|
| ➊ Removable silicone lining | ➋ Push button |
| ➌ Charging slots | ➍ Power port |
| ➎ Hearing instrument LEDs | ➏ USB power cable |
| ➐ Charger LED | ➑ Power adapter |
-

Standard Charger



- ❶ Status LEDs
- ❷ Charging slots
- ❸ Non-detachable USB power cable
- ❹ Power adapter

You can use the following standard ear pieces:

	Standard ear pieces	Size
<input type="checkbox"/>	 Sleeve 3.0 Vented/Closed/ Power	
<input type="checkbox"/>	 Eartip 3.0 Open	
<input type="checkbox"/>	 Eartip 3.0 Tulip	

You can easily exchange the standard ear pieces. Read more in section "Maintenance and care".

Custom-made ear pieces

-  Earmold 3.0

Controls

With the rocker switch you can, for example, switch hearing programs. The Hearing Care Professional has programmed your desired functions to the rocker switch.

Rocker switch function	L	R
Press briefly:		
Program up/down	<input type="checkbox"/>	<input type="checkbox"/>
Volume up/down	<input type="checkbox"/>	<input type="checkbox"/>
TV stream on/off	<input type="checkbox"/>	<input type="checkbox"/>
Press for about 2 seconds:		
Program up/down	<input type="checkbox"/>	<input type="checkbox"/>
Volume up/down	<input type="checkbox"/>	<input type="checkbox"/>
TV stream on/off	<input type="checkbox"/>	<input type="checkbox"/>
Press for more than 3 seconds:		
Turn on/off	<input type="checkbox"/>	<input type="checkbox"/>

L = Left, R = Right



You can also use a remote control to change hearing programs and adjust the volume of your hearing aids. With our smartphone app you have even more control options.

Hearing programs

1

2

3

4

5

6

Read more in section "Changing the hearing program".

Daily use

To assure comfortable and easy use of your hearing aids they are equipped with an onboard control element.

In addition, we offer an app for Android as well as iPhones which makes handling your devices even easier. Contact your Hearing Care Professional for downloading and installing the smartphone app.

Inserting and removing the hearing aids

Your hearing aids have been fine-tuned for your right and left ear. Colored markers indicate the side:

- red marker = right ear
- blue marker = left ear



Inserting a hearing aid:

- ▶ For Sleeves, take care that the bend of the Sleeve is in line with the bend of the receiver cable.

See the following illustrations.

Correct:

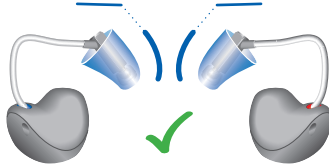

Incorrect:

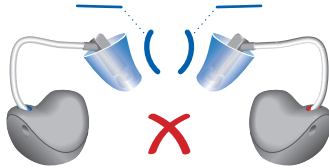

- ▶ Hold the receiver cable at the bend closer to the ear piece.
- ▶ Carefully push the ear piece in the ear canal **1**.
- ▶ Twist it slightly until it sits well.
Open and close your mouth to avoid accumulation of air in the ear canal.
- ▶ Lift the hearing aid and slide it over the top of your ear **2**.

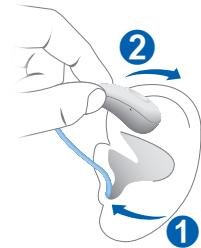



CAUTION

Risk of injury!

- ▶ Always wear the receiver cable with an ear piece.
- ▶ Make sure that the ear piece is completely attached.



CAUTION

Risk of injury!

- ▶ Insert the ear piece carefully and not too deeply into the ear.



CAUTION

Risk of injury!

- ▶ In very rare cases the ear piece could remain in your ear when removing the hearing aid. If this happens, have the ear piece removed by a medical professional.



- It may be helpful to insert the **right** hearing aid with the **right** hand and the **left** hearing aid with the **left** hand.
- If you have problems inserting the ear piece, use the other hand to gently pull your earlobe downwards. This opens the ear canal and eases insertion of the ear piece.

The optional retention strand helps to securely retain the ear piece in your ear. To attach the optional retention strand:

- ▶ Align the end of the retention strand with the flat end of the receiver.



- ▶ Then press the retention strand towards the receiver until it clicks into place.



- To position the retention strand:
- ▶ Bend the retention strand and position it carefully into the bottom of the bowl of your ear (refer to the picture).

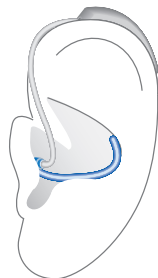

Removing a hearing aid:

- ▶ Lift the hearing aid and slide it over the top of your ear **1**.
 - ▶ If your hearing aid is equipped with a custom shell or a mold, remove it by pulling the small removal cord toward the back of your head.
 - ▶ For all other ear pieces: Grip the receiver in the ear canal with two fingers and pull it carefully out **2**.
- Do not pull the receiver cable.

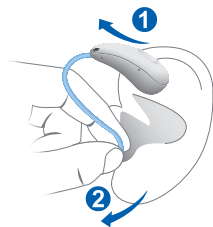

Clean and dry your hearing aids after usage. Read more in section "Maintenance and care".

Turning on and off

You have the following options to turn your hearing aids on or off.

Via charger:

- ▶ Turning on: Take the hearing aids out of the charger.
The startup melody is played in your hearing aids. The **default** volume and hearing program are set.
- ▶ Turning off: Place the hearing aids in the charger.

Note that the charger must be connected to the power supply. For details refer to the charger's user guide.

Via rocker switch:

- ▶ Turning on: Press and hold the lower part of the rocker switch until the startup melody starts to play. Release the rocker switch while the melody is playing.



The **default** volume and hearing program are set.

- ▶ Turning off: Press and hold upper or lower part of the rocker switch for several seconds. A power down melody is played.



Switching to standby mode

Via remote control, you can switch your hearing aids to standby mode. This mutes the hearing aids. When you leave standby mode, the **previously** used volume and hearing program are set.

Note:

- In standby mode, the hearing aids are **not** turned off completely. They draw some power.

Therefore we recommend to use standby mode only for a short period of time.

- If you want to leave standby mode, but the remote control is not at hand: Turn your hearing aids off and on again (via rocker switch or by shortly placing them in the charger until the LEDs light up). In this case, the **default** volume and hearing program are set.

Adjusting the volume

Your hearing aids automatically adjust the volume to the listening situation.

- ▶ If you prefer manual volume adjustment, press the upper part of the rocker switch to increase the volume or press the lower part to decrease the volume.

Refer to section "Controls" for the setting of your rocker switch.

An optional signal can indicate the volume change. Once the maximum or minimum volume has been reached, you may hear an optional signal tone.

Changing the hearing program

Depending on the listening situation, your hearing aids automatically adjust their sound.

Your hearing aids may also have several hearing programs which allow you to change the sound, if needed. An optional signal tone can indicate the program change.

- ▶ To change the hearing program, press the rocker switch briefly.

Refer to section "Controls" for the setting of the rocker switch. Refer to section "Hearing programs" for a list of your hearing programs.

The default volume is applied.

Charging with the Standard Charger

- ▶ Connect the charger to the power supply.

LEDs for each charging slots blink 3 times to indicate that the charger has power and is ready for use.

- ▶ Put the hearing aids in the charging slots as shown in the picture. You can charge both hearing aids at the same time.

The hearing aids are automatically turned off and start charging. The charging status is indicated, see table "Charging status" on the next pages.



- ▶ When you want to use your hearing aids, take them out of the charger. They will automatically turn on.
- ▶ You can leave the charger plugged in or remove it from the power supply.



NOTICE

Please make sure that the power plug is easily accessible to remove it from power supply if necessary.





Correct position of the hearing aids

- ▶ If not indicated differently, the left and right hearing aids can be inserted into either charging slot. The slots are not side specific.
- ▶ Make sure the bottom parts of the hearing aids are placed well into the charging slots.



Correct placement will be indicated by the LED.

Charging status

LED	Status description
	No LED light: Charger is not connected to power supply. No hearing aid is inserted in the respective charging slot or the hearing aid is not inserted correctly.
 3x	Green LED light blinks 3 times: Charger is connected to a power supply and ready to charge.
	Flashing green LED light: Charging in progress.
	Solid green LED light: Hearing aid is fully charged.
 3x	Red LED light blinks 3 times in 2 seconds: Error Read more in section "Troubleshooting".

Charging with the Travel Charger

- ▶ Connect the charger to the power supply.
- ▶ Charging of the internal battery now starts. This is indicated by the pulsing green LED light of the charger.
- ▶ When hearing instruments are inserted, they start charging as well. This is indicated by the pulsing green LED light of the hearing instruments LED..
- ▶ The charging status is shown permanently.



NOTICE

Please make sure that the power adapter is easily accessible to remove it from power supply if necessary.

Turning the charger on or off

When the charger is connected to an electrical outlet, it is automatically turned on and cannot be turned off.

During mobile charging, press and hold the button for 5 seconds to turn the charger on or off.







- ▶ When the charger turns on, the status of the hearing instruments and the status of the charger's internal battery are displayed for 7 seconds.
- ▶ When the charger turns off, the front LED lights up green and fades out over a period of approximately 7 seconds. Shut down is complete after approximately 7 seconds.

Charging hearing aids

- ▶ As illustrated, place the right hearing instrument in the charging slot marked with an "R", and the left hearing instrument in the charging slot marked with an "L".
- ▶ Make sure the bottom parts of the hearing aids are placed well into the charging slots.
- ▶ Correct placement will be indicated by the LED.
- ▶ Close the charger's lid.
- ▶ The hearing instruments are automatically turned off and start charging. The charging status is shown for 7 seconds.
- ▶ You can charge both hearing instruments at the same time.



Charging status

LED	Status description
	No LED light: No hearing instrument is in the charger, a hearing instrument is not placed correctly, or the charger is discharged.
	Flashing green LED light: Charging in progress.
	Solid green LED light: Hearing aid is fully charged.
 3x	Red LED light blinks 3 times in 2 seconds: Error Read more in section "Troubleshooting".
	Solid orange The internal battery does not have enough capacity to fully charge a pair of hearing instruments.
	Blinking orange The internal charger battery is empty. Charging of hearing instruments is not possible.

Low power indication

You will hear an alert signal to indicate the power cell is running low. The signal will be repeated every 20 minutes. Depending on the usage of your hearing aids, you have approximately 1.5 hours to charge your hearing aids before they stop working. Note that the power cell runtime is reduced if too many features are used simultaneously.

Charging tips

You may have some questions on how to best charge your hearing aids. Read the questions and answers below. If you have more questions, your Hearing Care Professional will help you.

How often do I need to charge the hearing aids?

We recommend charging the hearing aids daily, even if the power cell is not empty. Charge them overnight so you can be sure to start your day with fully-charged hearing aids.

How long does charging take?

A full charging cycle takes approximately 3 to 4 hours.

After 30 minutes, it is possible to use your hearing aids for up to 7 hours.

Charging times may vary due to the use of the hearing aids and the age of the power cell.

Can I leave the hearing aids in the charger?

Even when fully charged, you can leave the hearing aids in the charger. They automatically stop charging when they are fully charged.

What happens if I forgot to charge?

Your hearing aids will automatically switch-off when the power cell is empty. Charge the hearing aids as soon as possible.

Hearing aids which have not been charged for over 6 months may be damaged due to an unrecoverable deep-discharge of the power cell. Deep-discharged power cells cannot be charged anymore and have to be replaced.

 **What if I intend not to use the hearing aids for several days or longer?**

- Short-term storage (up to several days): Turn off your hearing aids via the push button or place them in the powered charger.

The charger must be connected to the power supply. If the charger is not connected to power supply and you place your hearing aids in the charger, the hearing aids are **not** turned off.

Note that when you turn off the hearing aids via a remote control or smartphone app, the hearing aids are **not** turned off completely. They are in standby-mode and still draw some power.

- Long-term storage (weeks, months, ...): First, fully charge your hearing aids. Turn them off via the push button before storing them. We recommend to use drying products while storing the hearing aids.

At 6 month intervals you will have to charge the hearing aids to avoid an unrecoverable deep-discharge of the power cell. Deep-discharged power cells cannot be charged anymore and they have to be replaced. We recommend recharging more frequently than 6 months intervals.

Observe the storage conditions in hearing aids' user guide.

Ask your Hearing Care Professional for recommended drying products.

 **What should I pay attention to when charging?**

The hearing aids and charger must be clean and dry. Observe the operation conditions in section "Operating, transport, and storage conditions". Avoid charging at high ambient temperatures, as this can shorten the life span and capacity of the power cell.

If you use the charger in a very warm environment, note that it will stop charging in order to cool down if the charger's temperature exceeds 45 °C. The LED light will blink 3 times in 2 seconds when this happens. Charging resumes automatically after the device has cooled down. Do not touch the hearing aids, they may be hot.

 **What should I pay attention to when using a power strip with energy-saving features?**

- Turn on the power strip **before** you insert the hearing aids in the charger. Otherwise, the hearing aids may not be detected by the charger.
- Do not turn off the power strip **while** the hearing aids are in charger. Otherwise the hearing aids will automatically turn on and discharge in the charger.

Before you turn off the power strip, remove the hearing aids from the charger and turn them off via the push button.

Special listening situations

On the phone

When you are on the phone, hold the telephone receiver slightly above your ear. The hearing aid and telephone receiver have to be aligned. Turn the receiver slightly so that the ear is not completely covered.

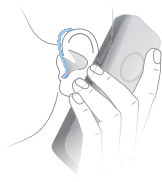

Telephone program

You may prefer a certain volume when using the phone. Ask your Hearing Care Professional to configure a telephone program.

- ▶ Switch to the telephone program whenever you are on the phone.

If a telephone program is configured for your hearing aids, it is listed in section "Hearing programs".

Audio streaming with iPhone

Your hearing aids are Made for iPhone hearing aids. This means you can get phone calls and listen to music from your iPhone directly into your hearing aids.

For more information about compatible iOS devices, pairing, audio streaming and other useful functions, contact your Hearing Care Professional.



Audio streaming with Android phone

If your mobile phone supports Audio Streaming for Hearing Aids (ASHA), you can get phone calls and listen to music from your mobile phone directly into your hearing aids.

For more information about compatible Android devices, pairing, audio streaming and other useful functions, contact your Hearing Care Professional.

Bluetooth

Your hearing aids are equipped with Bluetooth wireless technology to enable audio streaming from mobile phones or other compatible devices.

In an airplane, the use of Bluetooth functionality may be restricted, especially during take-off and landing. If this is the case, you can switch off Bluetooth wireless technology in your hearing aids via the smartphone app.

Audio induction loop (BiCore C R-Li T only)

Some telephones and public places like theatres offer the audio signal (music and speech) via an audio induction loop. With this system, your hearing aids can directly receive the desired signal – without distracting noise in the environment.

You can usually recognize audio induction loop systems by certain signs.



Whenever you are in a place with an audio induction loop:

- ▶ Switch to the telecoil program.

If a telecoil program is configured for your hearing aids, it is listed in section "Hearing programs".

Maintenance and care

To prevent damage it is important that you take care of your hearing aids and follow a few basic rules, which will soon become a part of your daily routine.

Hearing aids

Cleaning

Your hearing aids have a protective coating. However, if not cleaned regularly you may damage the hearing aids or cause personal injury.

- ▶ Clean your hearing aids daily with a soft, dry tissue.
- ▶ Never use running water or immerse the devices in water.
- ▶ Never apply pressure while cleaning.
- ▶ Do not use alcoholic solvent on the charging contacts.
- ▶ To avoid corrosion, use a soft and dry tissue to wipe off sweat or liquid from the charging contacts or hearing aids before inserting them in the charger.
- ▶ Ask your Hearing Care Professional for recommended cleaning products, special care sets, or more information on how to keep your hearing aids in good condition.



Drying

You can use conventional products to dry your hearing aids. Ask your Hearing Care Professional

for recommended drying products and for individual instructions on when to dry your hearing aids.

Storage

- Short-term storage (up to several days): Turn off your hearing aids via the rocker switch or place them in the powered charger.

Note that when you turn off the hearing aids via a remote control or smartphone app, the hearing aids are **not** turned off completely. They are in standby-mode and still draw some power.

- Long-term storage (weeks, months, ...): First, fully charge your hearing aids. Turn them off via the rocker switch before storing them. We recommend using drying products while storing the hearing aids.

At 6 month intervals you will have to charge the hearing aids to avoid an unrecoverable deep-discharge of the power cell. Deep-discharged power cells cannot be charged anymore and they have to be replaced. We recommend recharging more frequently than 6 month intervals.

Observe the storage conditions in section "Operating, transport and storage conditions".

Ear pieces

Cleaning

Cerumen (ear wax) may accumulate on the ear pieces. This may affect sound quality. Clean the ear pieces daily.

For all types of ear pieces:

- ▶ Clean the ear piece right after removal with a soft and dry tissue.

This prevents that cerumen becomes dry and hard.

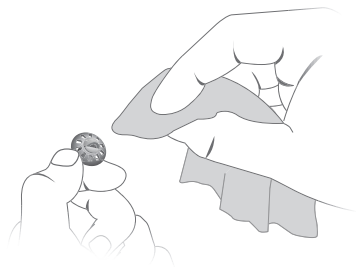

Charger



NOTICE

Risk of injuries caused by electric shock!

- ▶ If cleaning is required, disconnect the charger from the power supply.
- ▶ Clean the charger with a soft, dry tissue.
- ▶ Never use running water or immerse the charger in water.
- ▶ Do not sterilize or disinfect the charger.
- ▶ After use and before placing in the charger, wipe the charging pins on the hearing aids with a soft, dry tissue to remove grease or moisture.

Exchanging

Exchange standard ear pieces approximately every three months. Replace them sooner if you notice cracks or other changes. The procedure for exchanging standard ear pieces depends on the type of ear piece. In section "Components and names", your Hearing Care Professional has marked your type of ear piece.

- ▶ To remove the old Eartip or Sleeve, follow the illustration below. Be careful not to pull the receiver cable.

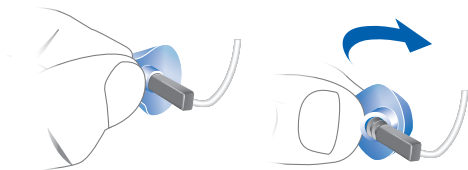

- ▶ Take particular care that the new Eartip or Sleeve covers the retention rings of the receiver fully.
- ▶ Check the firm fit of the new Eartip or Sleeve.

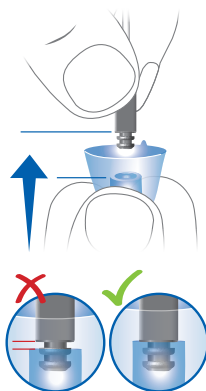



Professional maintenance

Your Hearing Care Professional can perform a thorough professional cleaning and maintenance.

Custom-made ear pieces and wax filters should be exchanged as needed by your Hearing Care Professional.

Ask your Hearing Care Professional for your individual recommendation of maintenance intervals and for support.



Important safety information for hearing aids and charger



WARNING

Charging systems may interfere with measuring devices and electronic equipment.

- ▶ In hospitals: The charger complies with CISPR 35 and CISPR 32. Therefore the use of the charger in hospitals should be permissible. Nevertheless the charger may interfere with highly sensitive devices. In those cases appropriate steps shall be taken (increase distance from sensitive devices or disconnect the charger from power supply).



WARNING

Interference with implantable devices

- ▶ The device can be used with all electronic implants that comply with the ANSI/AAMI/ISO 14117:2012 Electromagnetic compatibility standard for human implants.
- ▶ In case your implant does not comply with the ANSI/AAMI/ISO 14117:2012 standard, consult the manufacturer of your implantable device for information about the risk of disturbance.

Personal safety



WARNING

Risk of burns!

- ▶ Do not place anything other than your hearing aids in the charger.



WARNING

Risk of electrical shock!

- ▶ Do not use obviously damaged devices and return them to point of sale.



WARNING

Choking hazard!

Your device contains small parts which can be swallowed.

- ▶ Keep hearing aids, batteries and accessories out of reach of children and mentally disabled persons.
- ▶ If parts have been swallowed consult a physician or hospital immediately.



WARNING

Note that any unauthorized changes to the product may cause damage to the product or cause injury.

- ▶ Use only approved parts and accessories. Ask your Hearing Care Professional for support.



WARNING

Risk of explosion!

- ▶ Do not use your device in explosive atmospheres (e.g. in mining areas).

Product safety



NOTICE

- ▶ Protect your devices from extreme heat. Do not expose them to direct sunlight.



NOTICE

- ▶ Protect your devices from high humidity.



NOTICE

- ▶ Do not dry your devices in the microwave oven.



NOTICE

Use of incompatible parts poses a risk of malfunction.

- ▶ Use only the power supply and country specific adapter that is provided with the charger.



NOTICE

Do not drop. Internal components may get damaged.



WARNING

Risk of injury!

- ▶ Do not use obviously damaged devices and return them to point of sale.

Safety information on lithium-ion rechargeable batteries



WARNING

A lithium-ion rechargeable battery is permanently built into your device. Incorrect use of the device can cause the lithium-ion rechargeable battery to burst.

Risk of injury, fire or explosion!

- ▶ Follow the safety instructions for lithium-ion rechargeable battery in this section.



WARNING

Risk of electric shock!

- ▶ Connect the charger only with a USB power supply which complies with IEC 60950-1 and/or IEC 62368-1.



WARNING

- Observe the operating conditions.
- Pay special attention to protect your device from extreme heat (e.g. fire, microwave oven, induction oven or other high induction fields) and sunlight.
- Charge your hearing aids only with the approved charger. Ask your Hearing Care Professional for support.
- Do not disassemble the device.
- Do not use the device in explosive atmospheres.
- Do not use devices that are deformed or obviously damaged.
- Do not use the device when its performance after charging decreases considerably. Return the device to your Hearing Care Professional.
- ▶ Do not dispose of the device in fire or water.



WARNING

- ▶ Replacement and repair have to be performed by a professional. Therefore:
- ▶ Do not repair or replace the lithium-ion rechargeable battery yourself.
- ▶ In the unlikely event of a lithium-ion rechargeable battery bursting or exploding, keep all combustible materials away.

In any of the above cases, return your device to the Hearing Care Professional.

For more safety information, refer to the safety manual supplied with the device.

Further information

Accessories

You can use the smartphone app for convenient remote control of your hearing aids. The app also allows you to deactivate signal tones, to create individual sound profiles and many more functions.

You can also use a remote control.

Consult your Hearing Care Professional for further information.

Operating, transport, and storage conditions for the hearing aid

The hearing aids operate in the following environmental conditions (also valid in between uses):

Operating conditions	Discharging	Charging
Temperature	0 to 50 °C 32 to 122 °F	10 to 35 °C 50 to 95 °F
Relative humidity	5 to 93 %	5 to 93 %
Atmospheric pressure	700 to 1060 hPa	700 to 1060 hPa

During extended periods of transport and storage, please observe the following conditions:

	Storage	Transport
Temperature (recommended)	10 to 25 °C 50 to 77 °F	-20 to 60 °C -4 to 140 °F
Temperature (maximum range)	10 to 40 °C 50 to 104 °F	-20 to 60 °C -4 to 140 °F
Relative humidity (recommended)	20 to 80 %	5 to 90 %
Relative humidity (maximum range)	10 to 80 %	5 to 90 %
Atmospheric pressure	700 to 1060 hPa	700 to 1060 hPa

Note that you have to charge the hearing aids at least every 6 months. We recommend to charge the hearing aids every 3 months. For details refer to section "Maintenance and care".

For other parts, such as the charger, other conditions may apply.



WARNING

Risk of injury, fire or explosion during shipment.

- ▶ Ship lithium batteries and hearing aids according to local regulations.

Operating, transport, and storage conditions for the charger

Operating conditions

Temperature	10 to 35 °C 50 to 95 °C
Relative humidity	20 to 75 %
Atmospheric pressure	700 to 1060 hPa

During extended periods of transport and storage, please observe the following conditions:

	Storage	Transport
Temperature	10 to 40 °C 50 to 104 °F	-20 to 60 °C -4 to 140 °F
Relative humidity	10 to 80 %	5 to 90 %
Atmospheric pressure	700 to 1060 hPa	700 to 1060 hPa

For other parts, such as hearing aids, other conditions may apply.

Technical data of the power supply adapter

Input voltage:	100-240 V AC
Input current:	0.5 A
Input frequency:	50-60 Hz
Output voltage:	5 V DC
Output current:	1 A

Disposal information

- ▶ To avoid environmental pollution, do not throw power cells or devices into household trash.
- ▶ Recycle or dispose of packaging, power cells and devices according to local regulations.

Troubleshooting for hearing aid

Problem and possible solutions

Sound is weak.

- Increase the volume.
- Charge the hearing aid.
- Clean or exchange the ear piece.

Hearing aid emits whistling sounds.

- Reinsert the ear piece until it fits securely.
- Decrease the volume.
- Clean or exchange the ear piece.

Problem and possible solutions

Sound is distorted.

- Decrease the volume.
 - Charge the hearing aid.
 - Clean or exchange the ear piece.
-

Hearing aid emits signal tones.

- Charge the hearing aid.
-

Hearing aid does not work.

- Turn the hearing aid on.
 - Charge the hearing aid. Observe also the status LEDs on the charger.
-

Consult your Hearing Care Professional if you encounter further problems.

Troubleshooting for charger

Problem and possible solutions

LED light is off.

- Check if the power supply is connected correctly.
-

LED light is blinking red 3 times.

An error in the charger has occurred.

- Take the hearing aids out of the charger and disconnect the charger from the power supply.
 - Reconnect the charger to the power supply and re-insert the hearing aids in the charging slots.
 - Charger has reached the temperature limit and needs to cool down. Charging is resumed when the temperature decreases below 45 °C.
-

If the LEDs are still blinking red:

- Take the hearing aids out of the charger and disconnect the charger from the power supply.
 - Contact your Hearing Care Professional for support.
-

Consult your Hearing Care Professional if you encounter further problems.

Symbols used in this document



Points out a situation that could lead to serious, moderate, or minor injuries.



Indicates possible property damage.



Advice, tips, and notable information.



CE compliance label, confirms compliance with certain European Directives, refer to section "Conformance information".



Indicates the legal manufacturer of the device.

Made for

iPhone | iPad | iPod

"Made for iPhone", "Made for iPad", and "Made for iPod" mean that an electronic accessory has been designed to connect specifically to iPhone, iPad, or iPod, respectively, and has been certified by the developer to meet Apple performance standards. Apple is not responsible for the operation of this device or its compliance with safety and regulatory standards. Please note that the use of this accessory with iPhone, iPad, or iPod may affect wireless performance.

Conformance information for the charger

The CE mark indicates conformity with the following European directives:

- Council Regulation 2017/745 (MDR)
- 2011/65/EU RoHS concerning the restriction of hazardous substances



The CE mark indicates conformity with certain European directives and regulations. The full text of the declaration of conformity can be obtained from www.wsaud.com/rexton/.

This device complies with Part 15B of the FCC Rules and with CAN ICES-003 / NMB-003.

Operation is subject to the following conditions:

- This device may not cause harmful interference,
- this device must accept any interference received, including interference that may cause undesired operation, and
- the user shall keep a minimal distance of 20 cm (8 in) during the charging process.

Country-specific information

USA and Canada

Certification information for hearing aids with wireless functionality:

BiCore C R-Li /BiCore C R-Li T

- HVIN: RFM003
- Contains FCC ID: 2AXDT-RFM003
- Contains IC: 26428-RFM003

Service and warranty

Serial numbers

Hearing aid

Left:

Right:

Service dates

1:

4:

2:

5:

3:

6:

Warranty

Date of purchase:

Warranty period in months:

Your Hearing Care Professional





Legal Manufacturer for hearing aids

WSAUD A/S
Nymøllevej 6
3540 Lyngbe
Denmark



0123

For Canada: Manufactured by WS Audiology Canada Inc.



Legal Manufacturer for charger

WSAUD A/S
Nymøllevej 6
3540 Lyngbe
Denmark



For Canada: Manufactured by WS Audiology Canada Inc.



Document No. D00281754

Order/Item No. 21025658

Rev 1.0, 02.2023 SIV-16007-23

© 02.2023, WSAUD A/S. All rights reserved.



21025658

www.rexton.com